



Hard Floor Cleaning Program

ROUTINE



AUTO SCRUB OR DAMP MOP CLEANING

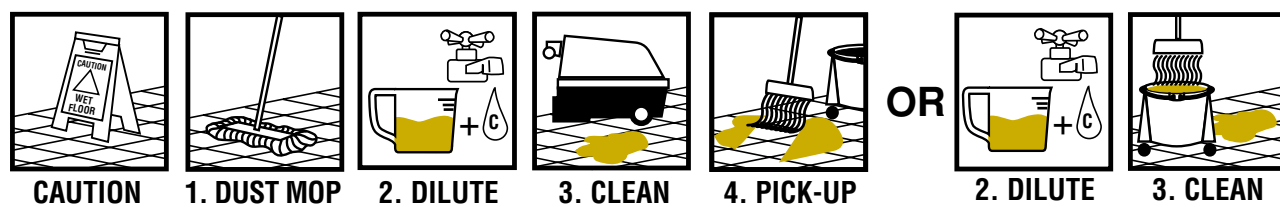

AUTO SCRUB CLEANING

1. **DUST MOP** the floor before applying cleaner.
2. **DILUTE:** Mix product according to label directions.
3. **CLEAN:** Scrub with red pad. Apply cleaning solution, scrub and pick up in one operation. Rinsing not required.
4. **PICK UP TRAILS:** Use clean water and mop/bucket to pick up any trails left from autoscrubber.

DAMP MOP CLEANING

1. **DUST MOP** the floor before applying cleaner.
2. **DILUTE:** Mix product according to label directions.
3. **CLEAN:** Using a clean mop, damp mop the floor. Change the cleaning solution frequently. No rinse required.

RESTORATION



AUTO SCRUB OR DAMP MOP CLEANING

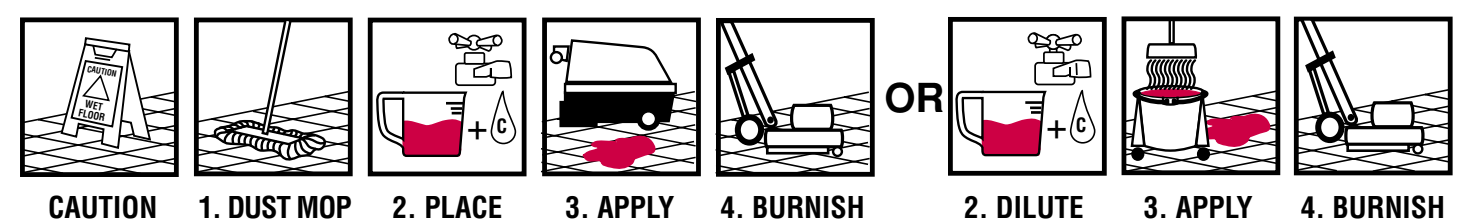

AUTO SCRUB CLEANING

1. **DUST MOP** the floor before applying cleaner.
2. **DILUTE** product according to label directions.
3. **APPLY** solution and scrub with a red or white pad. Vacuum up excess solution from floor.
4. **BURNISH** the floor when the solution is thoroughly dry to "pop the gloss".

DAMP MOP CLEANING

1. **DUST MOP** the floor before applying cleaner.
2. **DILUTE** product according to label directions.
3. **APPLY** solution to floor. Change solution when it becomes dirty. No rinsing required.
4. **BURNISH** the floor when the solution is thoroughly dry to "pop the gloss".

SCRUB & RECOAT



SCRUB & RECOAT

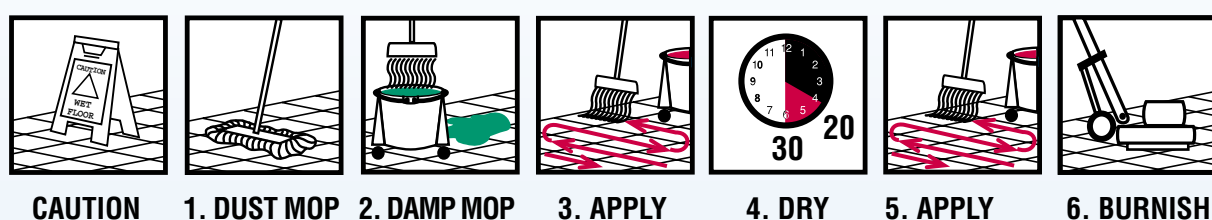

1. **DUST MOP** the floor. Remove gum, labels, and other attached soil deposits with a long-handled scraper or putty knife.
2. **DAMP MOP** or **AUTOSCRUB** using Fuller Cleaner and following the label directions.
3. **APPLY** a coat of Fuller Finish a clean mop.
4. **DRY** Allow 20-30 minutes drying time.
5. **APPLY** 2 coats. For best results allow adequate drying time between each coat.
6. **BURNISH** optional burnishing after last coat - wait 1 hour.

STRIPPING & FINISHING

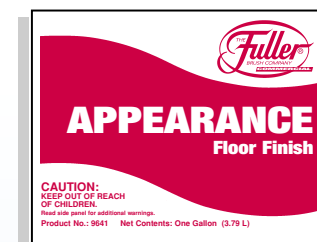
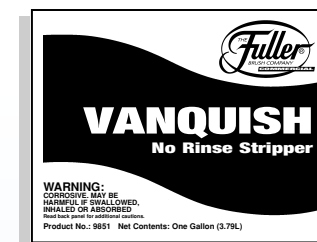

STRIPPING AND FINISHING

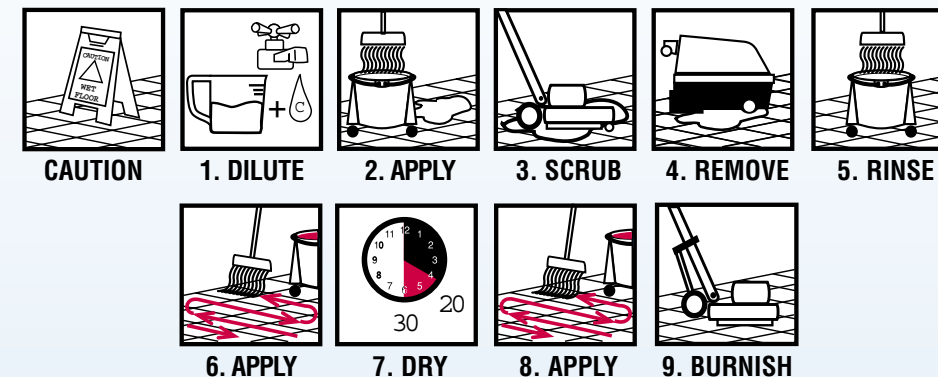

1. **DILUTE** product according to label directions.
2. **APPLY** the diluted solution liberally with a mop on a small section.
3. **SCRUB** the floor using a rotary machine and a black pad.
4. **REMOVE** the remaining solution off the floor using a mop or wet vacuum.
5. **RINSE** the floor with clean water and remove using a mop or wet vacuum.
6. **APPLY** 2 coats of Fuller Sealer a clean mop.
7. **DRY** Allow 20-30 minutes drying time between coats.
8. **APPLY** 4 coats of Fuller Finish. For best results allow adequate drying time between each coat.
9. **BURNISH** after last coat - wait 1 hour. (optional)



Distributed By:

MSDS Fax Retrieval:
800-551-0101

CHEMTREC Day or Night:
800-424-9300

TECH HOTLINE:
800-810-4829